

410-2329 Component Clip, .055 (1,40) Slot, Thread Mount

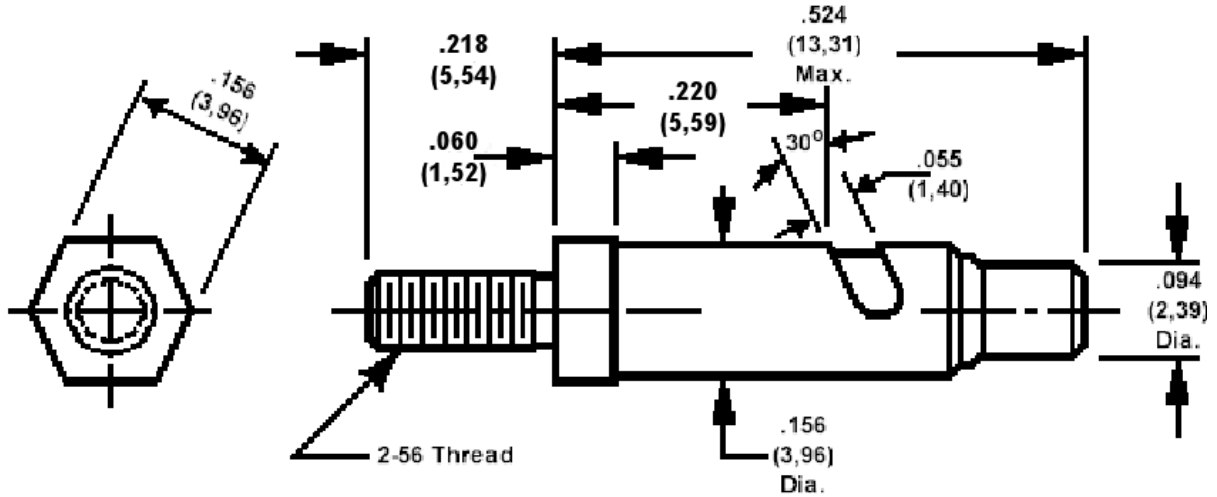

Recommended Lead Wire Sizes - #24 AWG (.020) (0,51) Min. Thru #17 AWG (.045) (1,14) Max.

How to order code
410-2329-01-02-00
Basic Part No.

Component	Material	Finish
Housing	Brass	Nickel
Plunger	Brass	Nickel
Spring	Cres. Steel	Passivated