

**461-8116 Shorting Links, Insulated, .040 (1,02) Diameter Pins
 Non-Magnetic**

(For non-insulated version see 360-8118)
 (For wider pitch between pins, see 461-8119)

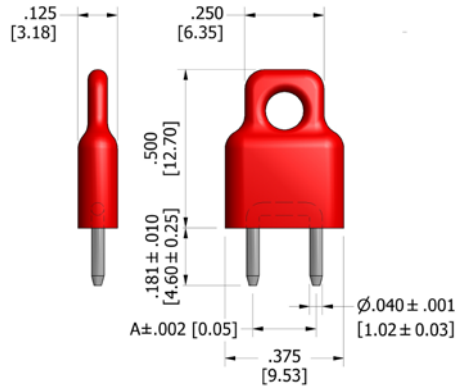

**How to order code
 461-8116-XX-YY-ZZ**

Basic Part No XX = A Dimension, YY = Plating Finish, ZZ = Colour

DIMENSIONS		
Basic Part No	Dash No (XX)	A Dimension
461-8116	-01	.200 (5,08)
	-02	.250 (6,35)

MATERIALS			
Component	Material	Finish (-03)	Finish (-04)
Pin	Brass, non-magnetic	Gold 0.75um over Copper	Electro-Tin over Copper
Insulator	Polypropylene	Select colour (see below)	

COLOUR (ZZ)		
-10	-12	-16
Black	Red	Blue

Dimensions in inches [mm]
 Tolerance unless otherwise stated ±.010 [0.25]